

PLEASE ENSURE YOU HAVE FULLY
READ AND UNDERSTOOD THIS
GUIDE BEFORE INSTALLATION!



Watch the video online

WWW.THERMOGROUPEUK.COM

5259 Touch Screen Thermostat Installation

YOUR STEP-BY-STEP GUIDE TO THE
PERFECT INSTALLATION



STOCK NO 5259



STOCK NO 5275

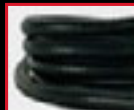

STOCK NO 5267

thermostats
TOTAL SYSTEM CONTROL

Thank you for your purchase...

A message from customer care

Thank you for choosing our 5259 Touch Screen Thermostat. Our commitment to simple, honest, on-time quality service ensures that we are here to help throughout every stage of your project from concept to installation and, most importantly, after sales support.

This document will provide a step-by-step guide to a perfect installation, details on your warranty and how to get Technical Support should you need it.

To ensure a safe, hassle free installation to be proud of please take the time to read this guide in full before reaching for your tools. We've taken the time to highlight any potential pitfalls and common errors so you can avoid them and get the job done!

This product is covered by a 3 year warranty, subject to terms and conditions. Be sure to keep your receipt as proof of purchase, as this will be required to validate your 3 year warranty.

If you have any questions about your thermostat call our Technical Support team on the freephone number below. We will do our best to find a solution for you and will always give that little bit extra...

Thanks again for choosing Thermogroup UK products.

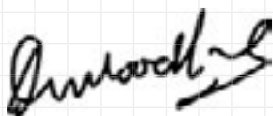

Duncan Woodford
Customer Services

Warranty, Terms & Conditions

Thermogroup UK supplied thermostats are covered by a full 3 year warranty from date of purchase. Thermostats found to be defective in material or workmanship will be replaced or repaired at Thermogroup UK discretion within 3 years of purchase date. Signs of abuse, misuse or alterations will void this warranty.

Thermogroup UK shall not be liable for any other expense, loss or damage; whether direct, indirect, incidental, consequential or exemplary arising in connection with the installation or use of or the inability to use Thermogroup UK underfloor heating systems.

No dealer, agent, employee or other representative of Thermogroup UK is authorised to extend or enlarge this warranty.



Watch the video online

WWW.THERMOGROUPUK.COM

CONTACT US ONLINE



Browse our full product range, watch videos, download product literature and get a quote, all on the Thermogroup UK website.

WWW.THERMOGROUPUK.COM

CONTACT US BY PHONE



Got a question or query? Call our UK support line free from your land line.
Open 07:30 – 16:30 Mon - Fri

0800 019 5899

CONTACT US BY MAIL



Need to find us or want to write a letter to say hello? Feel free to contact us at Bridge House.

**Thermogroup UK, Bridge House,
Hop Pocket Lane, Paddock Wood,
Kent. TN12 6DQ.**



Contents

Stage 1: How to install your thermostat

4-5

Step 1:	Conduit installation	4
Step 2:	Get an even temperature reading	4
Step 3:	Remove the face plate	4
Step 4:	Release the black steel wall plate	4
Step 5:	Remove the black steel wall plate	5
Step 6:	Fix the black steel wall plate to the back box	5
Step 7:	Wire up the thermostat	5
Step 8:	Detailed wiring schematic	5
Step 9:	Slide the thermostat into the back box	5
Step 10:	Clip the thermostat to the black steel wall plate	5
Step 11:	Replace the faceplate	5
Step 12:	Power up the thermostat	5

Stage 2: Programming your thermostat

6-7

Before you start:	Advanced settings - Sensor mode, Frost protection & Program options	6
Function 1:	Set the time & date	6
Function 2:	Manual mode	7
Function 3:	Heating schedule	7

! IMPORTANT SAFETY REGULATIONS !

ALL WIRING MUST CONFORM TO IEE 17TH EDITION AND PART P REGULATIONS

IP32

5259 is IP32 rated so is suitable for safe installation in bathrooms.

All electrical circuits in bathrooms must be protected by a 30mA RCD. The instructions we supply include as much information as possible to ensure that all installations comply with current electrical regulations. Please call our freephone customer care line if in any doubt on 0800 019 5899.

DO

- ✓ Install a conduit before thermostat installation.
- ✓ Ensure substrate is secure before inserting a groove for the conduit.
- ✓ Ensure Underfloor heating is protected by an adequate RCD.

DO NOT

- ✗ Ignore IP32 regulations.
- ✗ Install this thermostat in a wet zone.
- ✗ Turn on until all adhesives are fully cured.

Stage 1: How to install your thermostat

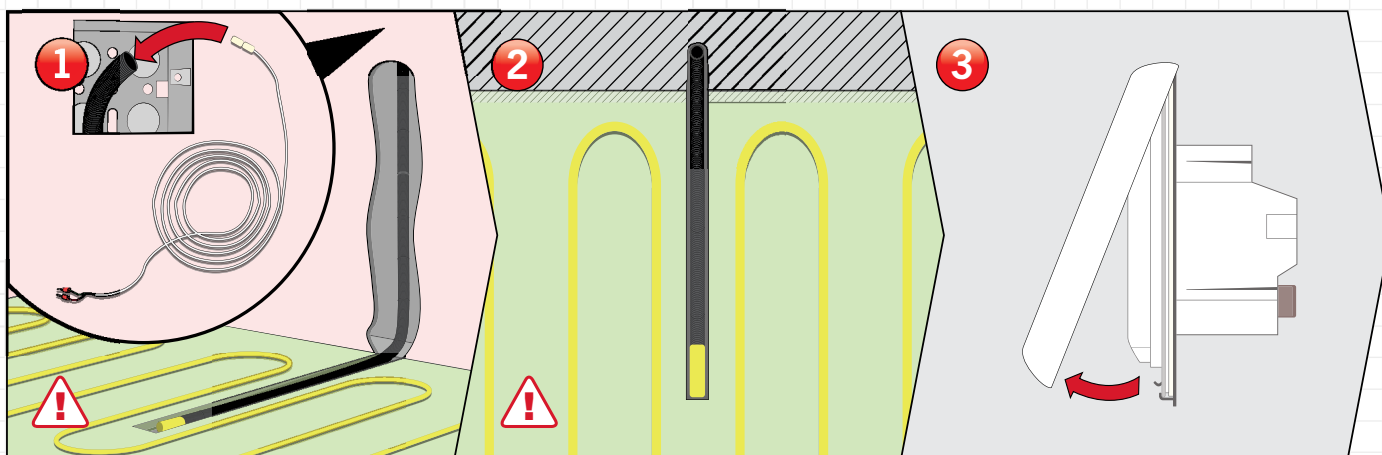

Step 1: Conduit Installation

Cavity wall: Position your conduit into your back box and feed it down through the wall cavity. Then feed your sensor probe cable down to the end of the conduit.

Concrete wall: Chase a channel out of your wall and floor, then lay the conduit in place. You will need to plaster over the top. Now feed the sensor probe to conduit.

Step 2: Getting an even temperature

The conduit and sensor should be positioned centrally between two runs of heating cable to allow for an accurate temperature reading.

✓ PRO TIP

Leave the yellow cap on your conduit and ensure sensor probe is pushed to the end.

Step 3: Removing the face plate

✓ PRO TIP

When mounted on the wall a flat head screw driver can be used to remove the facelplate.

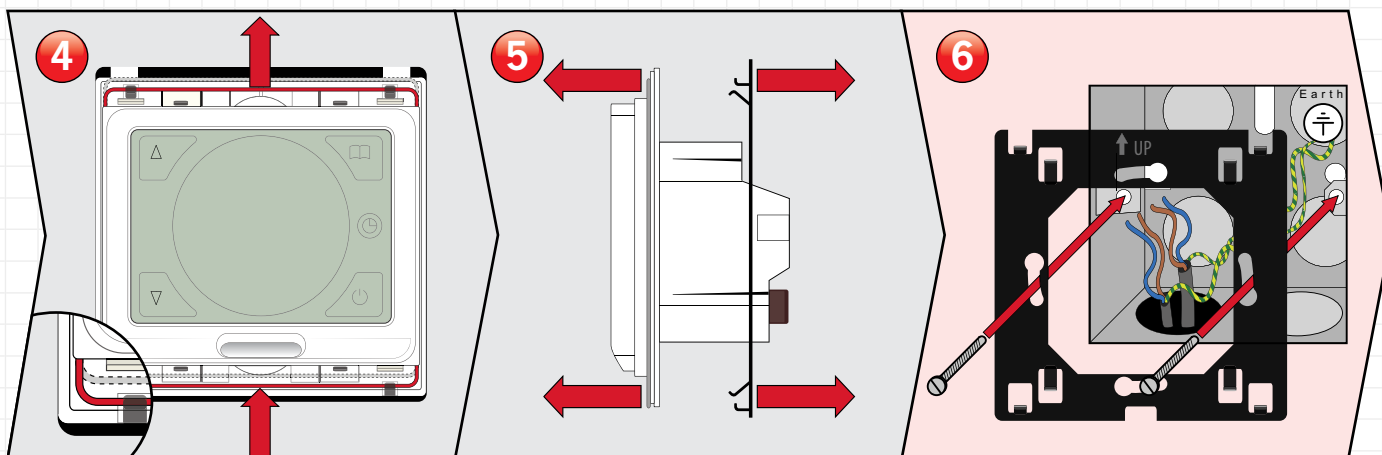

Step 4: Release the black steel plate

Carefully remove the white face plate. Now release the black steel wall plate simply push the steel wire clip in the direction shown and the black steel wall plate will be released.

Step 5: Remove the black steel plate

Pull the black steel wall plate away from the thermostat.

Step 6: Fix the black steel wall plate to the back box

Align the holes on the steel plate with the ones on the backbox in your wall. Fix in place with the supplied screws, taking care to ensure the mount is level.

Step 4: Checklist

- INSTALL CONDUIT IN CORRECT POSITION
- INSTALL SENSOR CABLE
- INSTALL STEEL WALL PLATE ENSURING ITS LEVEL AND SECURE

! IMPORTANT SAFETY PRECAUTIONS !

- MAKE SURE CONDUIT AND SENSOR ARE POSITIONED CENTRALLY BETWEEN 2 RUNS OF HEATING CABLE
- ENSURE CIRCUIT IS PROTECTED BY AN ADEQUATE RCD
- ENSURE THAT THE WIRING OF YOUR THERMOSTAT IS EXACTLY THE SAME AS STEP 8



Stage 1: How to install your thermostat

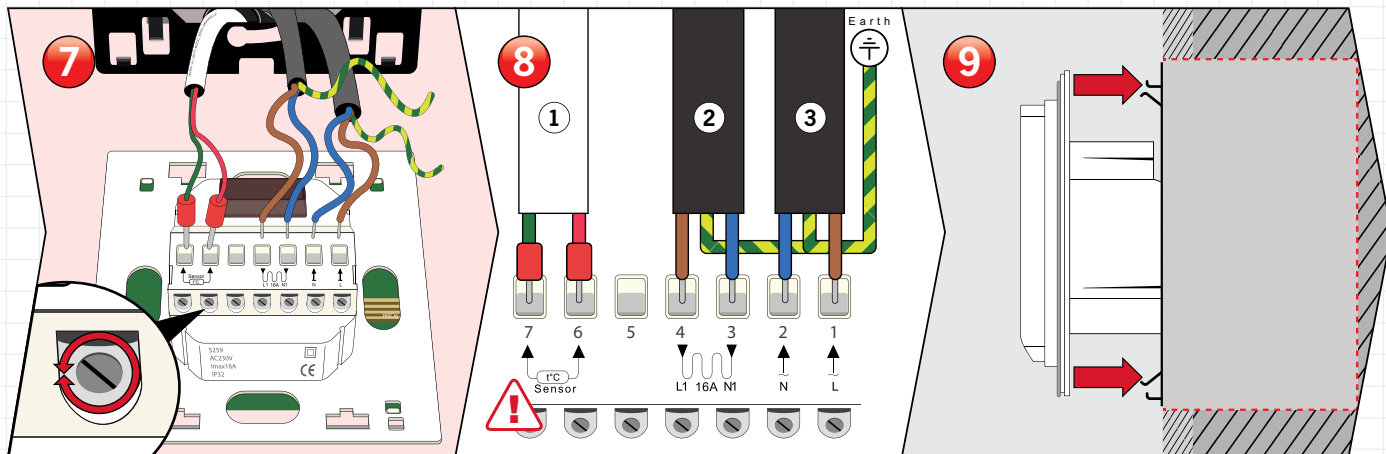

Step 7: Wiring the Thermostat

Pull the wires through from your heating system and expose if required. Loosen the tension screws to allow the wires to be inserted and fixed.

Step 8: Detailed wiring schematic

Position the cables as shown above and tighten the tension screws one by one.

- ① Sensor probe
- ② Heating cable cold tail
- ③ Power supply

✓ PRO TIP

Use a cable stripper to ensure a good amount of cable is exposed.

Step 9: Slide the thermostat into the back box

Slide the thermostat into position. Ensure the metal brackets on the black steel wall plate slide easily back into position.

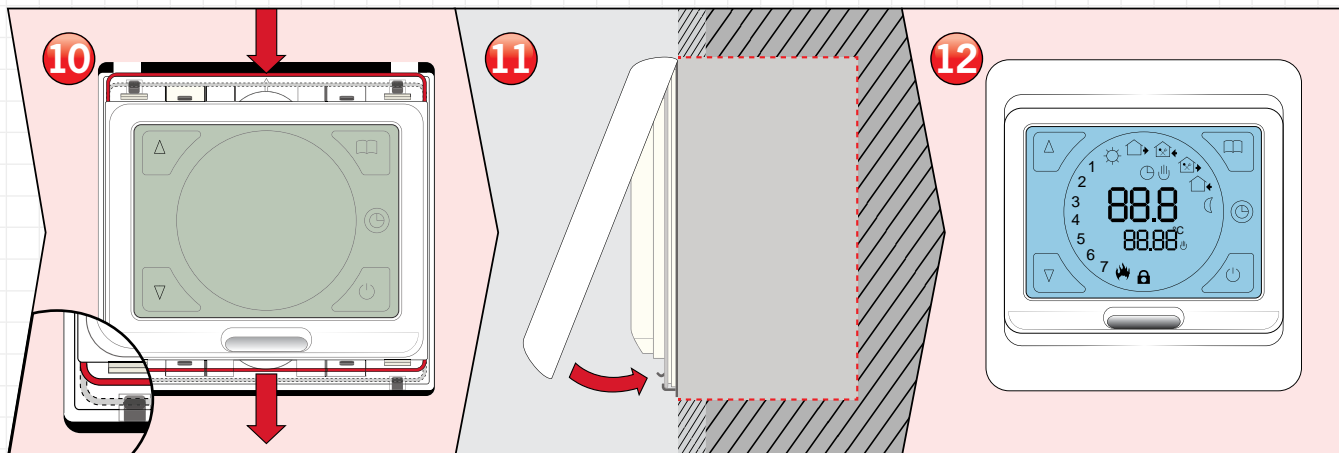

Step 10: Clipping the thermostat to the black steel wall plate

Gently push the steel wire clip down locking the thermostat in place.

✓ PRO TIP

Ensure circuit is protected by an adequate RCD unit (5266)

Step 11: Replacing the face plate

Clip the face plate into position. To remove the face plate whilst attached to the wall, gently use a flat headed screw driver in the notch on the underside.

✓ PRO TIP

Different coloured fascias are available, install at this point if you have one.

Step 12: Turn on the thermostat

Tap the 'power' button on the touch screen and begin to program the thermostat.

✓ PRO TIP

Snubber - If your underfloor heating system is over 16A you will need to install a contactor snubber. See the Advanced Electrical Guide online.

Step 4: Checklist

- WIRE THERMOSTAT CORRECTLY TO AN RCD
- INSTALL THERMOSTAT AND FACE PLATE
- THERMOSTAT POWERS UP

! IMPORTANT SAFETY PRECAUTIONS !



MAX LOAD 16A



KEEP SENSOR AND THERMOSTAT AWAY FROM HOT OR COLD EXTERNAL INFLUENCES SUCH AS PIPES







ALL ELECTRICAL WORK MUST COMPLY WITH IEE 17TH EDITION PART P REGULATIONS

Stage 2: Programming your thermostat

Before you start

5259 has some advanced settings which must be configured before programming. These include Sensor Setup, Frost Protection & Heating Schedule Options.

- 1 To access advanced settings switch the unit off by tapping the  button.
- 2 Then press and hold both the  and  button.
- 3 Tap the  button to switch to Sensor mode (2SEN) and set to OUT

Sensor mode

The 5259 has three sensor settings. Air Sensor (IN), Floor Sensor (OUT) and Air Sensor with Floor Limit (All). We recommend Floor Sensor (OUT) for the most accurate control. The thermostat sensor is defaulted to "IN" so should be changed before use.

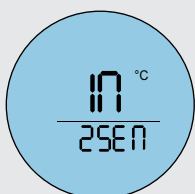

Air Sensor (IN)

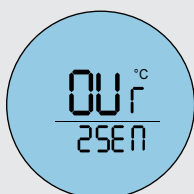



Floor Sensor (OUT)



Air Sensor with Floor Limit (All)

Frost Protection



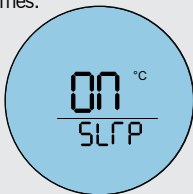

When set to ON, the built in frost protection feature will ensure the temperature of your substrate never dips below 10°C. This protects against frozen substrates and ensures economical heat up times.

- 4 Tap the  button until you see Frost protection mode (5LrP - pictured left).
- 5 Set this to "On" using the  and  arrows.





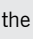



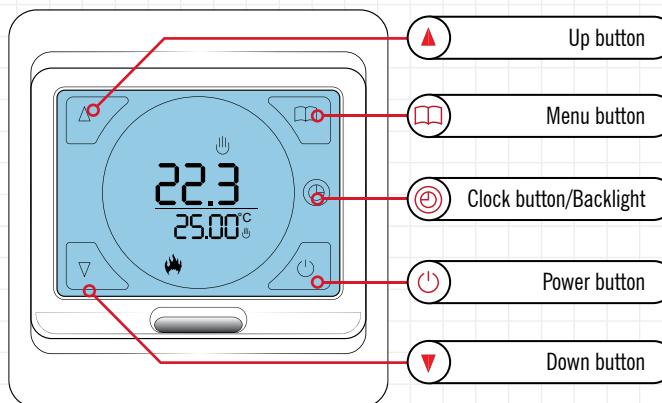
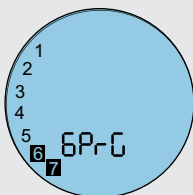

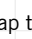

Heating Schedule options

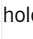
Your heating schedule can be configured to suit most lifestyles. The options are Mon – Fri (1-5) the same with Sat – Sun (6-7) separate. Mon – Sat (1-6) the same with Sun (7) separate and All Days (1-7) the same. You can also switch off the heating schedule if you require. 1-5 days settings have 3 comfort periods. 6-7 day settings has 1 comfort period.

- 6 Tap the  button to set your program days.
- 7 Tap  and  to set the program days.
- 8 Program options include:
 - Seven days same
 - Five days & weekend
 - Six days same & 1 separate day
 - Program off
- 9 Switch off to save your settings using the  button.

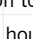















Function 1: Set the time & date

- 1 Tap the  button to switch unit on.
- 2 The backlight will fade after around 10 seconds.
- 3 Tap the  button to switch it back on at any point.
- 4 Press and hold the  button for around 7 seconds or until the minutes begin to flash.
- 5 Use the  and  arrows to select the correct minute.
- 6 Tap the  button to switch to hour and use  and  to select the correct hour.
- 7 Tap the  button again to edit the day.
- 8 Use the  and  arrows to select the correct day number: 1 = Mon 7 = Sun.

PRO TIP

The 5259 will go to a maximum of 27°C. We recommend a maximum of 25°C for efficiency. (High temperatures may damage your floor finish)

Icon key:	Button key:
 Manual control mode	 Clock button
 Period 1	 Menu button
 Period 2	 Power button
 Period 3	 Up button
 Period 4	 Down button
 Period 5	
 Period 6	
 Heating on	
 Program mode indicator	

Step 4: Checklist

- IS THE CONDUIT AND SENSOR PROBE IN POSITION
- EXPLORE ALL SETTINGS AND FEATURES
- SELECT PREFERRED ADVANCED SETTING

! IMPORTANT SAFETY PRECAUTIONS !



MAKE SURE ADVANCED SETTINGS ARE FINALISED BEFORE THERMOSTAT SETUP







BE SURE TO SELECT THE RIGHT MODE FOR THE RIGHT INSTALLATION. THE WRONG SETTING COULD COST YOU MONEY

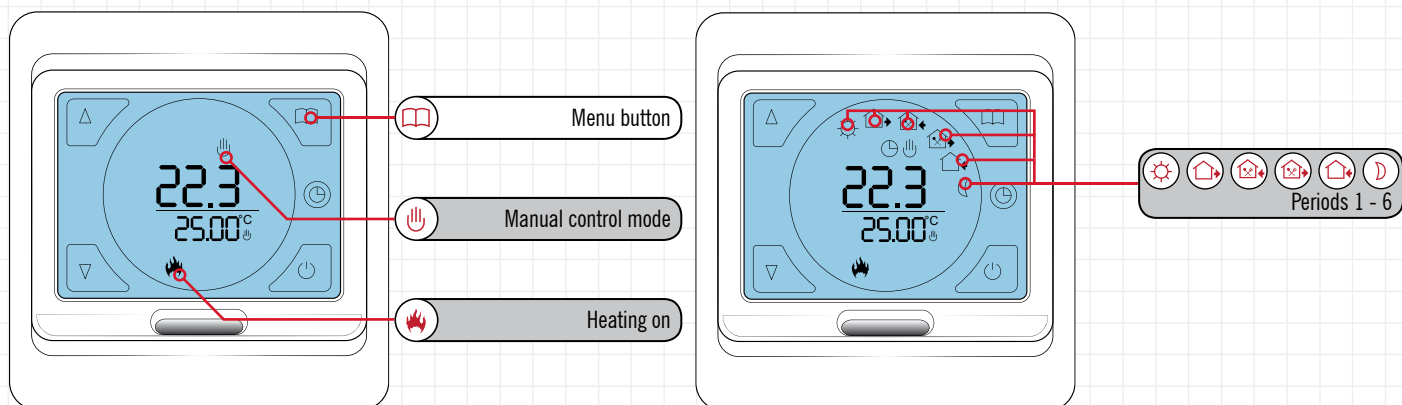























Stage 2: Programming your thermostat

















Function 2: Manual Mode



- 1 You can switch between Manual mode and your custom Schedule by tapping .
- 2 When in , set a target temperature manually using  and .
- 3 When the target temperature is set above the ambient temperature, you will see the  (Heating on) symbol below the target temperature. You may also hear a 'click'.



Function 3: Heating schedule

- 1 Tap  button to switch the unit into Schedule mode.
- 2 You will see both the  and  (Period 1 - 6) symbols displayed.
- 3 Press and hold  for 7 seconds to edit your schedule.
- 4 Firstly, set the start time for  (period 1) using the  and down  buttons.
- 5 Tap  to save your start time and set the Comfort Temperature to between 20°C and 27°C.
- 6 Tap  to advance to  (period 2) and select the desired time using  and .
- 7 Tap  to save your start time and set the Eco Temperature between 18°C and 20°C.
- 8 Tap  to advance to  (period 3) and select the desired time using  and .
- 9 Tap  to save your start time and set the Comfort Temperature to between 20°C and 27°C.
- 10 Tap  to advance to  (period 4) and select the desired time using  and .
- 11 Tap  to save your start time and set the Eco Temperature between 18°C and 20°C.

Function 3: Heating schedule continued

- 12 Tap  to advance to  (period 5) and select the desired time using  and .
- 13 Tap  to save your start time and set the Comfort Temperature to between 20°C and 27°C.
- 14 Tap  to advance to  (period 6) and select the desired time using  and .
- 15 Tap  to save your start time and set the Eco Temperature between 18°C and 20°C.
- 16 Now you have a set schedule for 5 days. Tap  to set your weekend heating.
- 17 Select a later start time if you like a lie in. This time will apply to both days.
- 18 Tap  to save your start time and set the Comfort Temperature between 20°C and 27°C.
- 19 Tap  to save your temperature and advance to  (Period 2).
- 20 Set the desired start time and set the Eco Temperature between 18°C and 20°C.
- 21 You should now have a complete 7 day heating schedule!
- 22 Simply tap  (Power) to activate your schedule and you're done.



 **PRO TIP**
Tap the  icon to switch on the backlight

 **PRO TIP**
Press and hold the  and  to lock the screen, press and hold again to unlock.

Step 4: Checklist

- ASSIGN HEATING SCHEDULE
- RECOGNISE MINIMUM AND MAXIMUM TEMPERATURE
- EXPLORE ALL ICONS AND BUTTONS

! IMPORTANT SAFETY PRECAUTIONS !

-  **BE SURE TO PRESS THE MENU/ POWER BUTTON TO SAVE YOUR SETTINGS. SETTINGS MAY BE LOST OTHERWISE**
-  **SETUP YOUR HEATING SCHEDULE TO FIT WITH YOUR LIFESTYLE, THIS WILL GIVE YOU THE BEST RESULTS**

Technical Specification

Terminal Sizes	Voltage	Protective Housing	Size	Temperature Gradient	Power Consumption	Ambient Temperature	Setting Range	Max Load
0.32 – 2.1mm ²	230V	IP32	(H) 90mm x (W) 86mm x (D) 43mm/ 13mm to wall	0.5 - 10°C adjustable	2W	0.5 ~ 50°C	5 – 90°C	16A / 3600W

CONTACT US ONLINE



Browse our full product range, watch videos, download product literature and get a quote, all on the Thermogroup UK website.

WWW.THERMOGROUPUK.COM

CONTACT US BY PHONE



Got a question or query? Call our UK support line free from your land line.
Open 07:30 – 16:30 Mon - Fri

0800 019 5899

CONTACT US BY MAIL



Need to find us or want to write a letter to say hello? Feel free to contact us at Bridge House.

**Thermogroup UK, Bridge House,
Hop Pocket Lane, Paddock Wood,
Kent. TN12 6DQ.**



Thermogroupuk

SUSTAINABLE HEATING SOLUTIONS

**Thermogroup UK
Bridge House
Hop Pocket Lane
Paddock Wood
Kent
TN12 6DQ**

0800 019 5899

sales@thermogroupuk.com

www.thermogroupuk.com

E&OE © Thermogroup UK 2012